



DLR1060 Two-Way Radio Quick Reference Guide

This Quick Reference Guide covers the basic operation of the radio.

Ensure your battery is fully charged before first use.

The DLR Series operates in the license-free 900 MHz ISM Band.

For more information on product details, user guide, brochures, and accessories, refer to http://www.motorolasolutions.com/map/en_xa/dlr or call 1-800-931-855.

Radio Overview

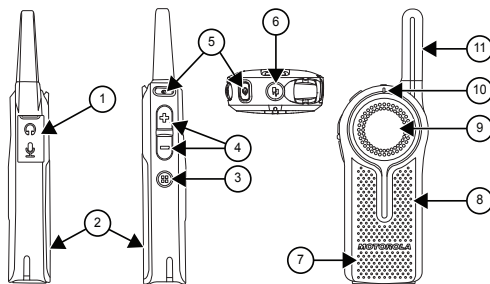

- | | |
|-----------------------------------|------------------------------|
| 1. Audio Accessory Connector | 7. Speaker |
| 2. Battery | 8. Microphone |
| 3. Channel/Menu Button | 9. Push-To-Talk (PTT) Button |
| 4. Volume Up/Down Control Buttons | 10. Tx/Rx LED Indicator |
| 5. Power Button | 11. Antenna |
| 6. Top Button | |

Getting Started

For more information, refer to the User Guide in https://www.motorolasolutions.com/content/dam/msi/docs/en_xa/DLR-UserGuide.pdf.

Attaching the Battery

- Slide the latch at the top of the battery door to the unlock position and lift the battery door at the center recess.
- Align the battery contacts with the tabs in the battery compartment. Insert the contact side of the battery first, then press the battery down to secure in place.
- Put the battery door back on the radio. Slide the latch to the lock position.

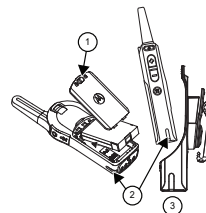

1. Battery Latch
2. Lateral Battery Slot
3. Holster

Charging the Battery

- Connect the power supply to the drop-in charger tray or a power cord to the multi-unit charger.
- Insert the radio into the tray, make sure that the lateral battery slots are inserted in the tray rails. The charger LED flashes a few times, indicating the battery is charging.

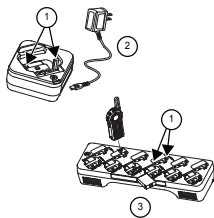

1. Tray Rail
2. Drop-in Tray Charger with Power Supply
3. Multi-unit Charger

**Notice:**

The light on the charger is red when the radio is charging. It turns to green once the radio is fully charged. If fast blinking red, it indicates a fault condition.

Turning the Radio On or Off

- 1 Long press the **Power** button to turn on the radio. The radio sounds the power up tone and the Tx/Rx LED Indicator blinks.



Notice: The radio announces the current channel, and battery level when the power is on.

- 2 Long press the **Power** button to turn off the radio. The radio sounds the power down tone and the Tx/Rx LED Indicator turns off.

Setting the Non-Interference or Privacy Feature

This feature ensures non-interference and improved private communications by configuring a Profile ID.



Important: By default, the Profile ID number is "0000". Ensure your radios are configured with the same Profile ID number.

- 1 Turn the radio off.
- 2 Press the **PTT**, **Volume Up Control**, and **Power** buttons at the same time. The radio powers up and announces "Programming Mode".
- 3 Press the **Channel/Menu** button. The radio announces "Current Profiled ID <Number>".
- 4 Press the **Volume Up Control** or the **Volume Down Control** buttons to change each Profile ID digit. Press the **Menu** button to change from one digit to the next. The radio announces the new number when all Profile ID digits are changed.
- 5 Long press the **PTT** button to exit the setting.

Transmitting and Receiving Calls

- 1 Press the **PTT** button to respond.



Notice: Wait for the Talk Permit Tone to end and speak. If you receive a busy tone, the channel is either not available, busy, or there is no user reachable within transmission range.

- A quick double beep is heard.
- 2 Hold the radio vertically by 1 to 2 in. from mouth when speaking into the microphone.
 - 3 Release the **PTT** button to listen.

Table 1: Tx/Rx LED Indicator

Indicator	Status
Slow blinking red	The radio is on standby.
Solid red	The radio is in transmission mode.
Fast blinking red	The radio is in receiving mode.

Adjusting the Volume

- 1 Press the **Volume Up Control** button to increase the volume.
- 2 Press the **Volume Down Control** button to decrease the volume.

Changing Channels

- 1 Press the **Channel/Menu** button.
The radio announces the current channel.
- 2 Press the **Volume Up Control** or **Volume Down Control** button.
The channel is changed, and the radio announces the new channel.



Notice: It is not necessary to wait for the radio announcement to be completed before continuing with the next button press.

- 3 Press the **PTT** button to exit.

Battery Status

Short press the **Power** button.
The radio announces the battery status.

Starting a Private Reply

The **Top** button is set as Private Reply feature by default. This feature allows two people to instantly connect privately after a group transmission is over.



Important: There is a channel Hangtime after a Private transmission. By default, the Hangtime is set to 10 seconds.

- 1 To initiate a Private Reply, press the **Top** button during a group call.
The **Top** button LED blinks orange.
- 2 After a group call, press **PTT** button to call privately.
The **Top** button LED illuminates in solid orange.
- 3 Wait for the Talk Permit Tone to end and speak.

Advanced Configuration Mode or Other Features

The DLR Series allows for other special features such as Profile ID, Maximum Channels, Top Button, Microphone (MIC) Gain, Home Channel, and Instant Mute through Advanced Configuration Mode. The following explains how this feature is set.

With the radio turned off, press the **Power**, **PTT**, and **Volume Up Control** buttons simultaneously.
The radio enters Advanced Configuration Mode, and the radio announcement is heard.

Copyrights

The AMBE+2™ voice compression software included in this product is protected by intellectual property rights including patent rights, copyrights and trade secrets of Digital Voice Systems, Inc. This voice compression technology is licensed solely for use as is within the Communications Equipment. US Patent Nos.: #8,595,002 B2, #8,359,197, #8,315,860, #8,200,497, #7,970,606, #6,912,495 B2, #6,199,037 B1, #5,826,222, #5,754,974, #5,701,390, and #5,715,365.

Trademarks

MOTOROLA, MOTO, MOTOROLA SOLUTIONS and the Stylized M logo are trademarks or registered trademarks of Motorola Trademark Holdings, LLC and are used under license. All other trademarks are the property of their respective owners.

© 2019 Motorola Solutions, Inc.

All rights reserved.



MN006344A01-AA

Printed in



